

## TC100 - CORNER WRAP LABELLING

TC100 is a complete solution for corner wrap box labelling. The system can manage high-speed side-back labelling at up to 25 boxes per minute. It's ideal when you need bar-codes and text on two sides of your box!

The TC100 has the reliable, robust and easy to use design - as seen on all the Mectec family machines. It is proven to give you 24 hours reliable labelling for many years to come - even in the most harsh industrial environments!

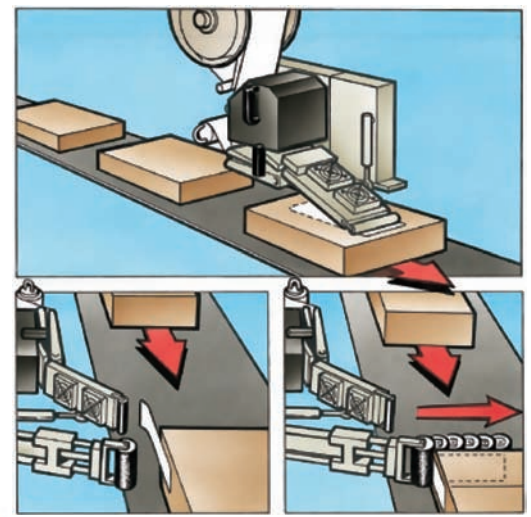

Box and parcel labelling.  
 Applies on moving products!

Printer, applicator and pusher in right hand version



Handheld terminal TG300 (optional)



Printer Control Unit PCU III

TECHNICAL DATA	
Type of applicator:	Wipe on Separate corner wrap roller
Tamp size:	110 x 300 mm
Print speed:	Up to 275 mm/sec
Resolution:	8 or 12 dots/mm 200/300 DPI
Interface:	2 x RS232, 1 x RS485, 1 x USB 2.0 (Ethernet optional)
Overall dimensions:	741 x 614 x 258 mm (l x h x w) - P & A (length is measured without the pusher) 406 x 265 x 128 mm (l x h x w) - PCU III
Controller functions:	On-Line and Stand Alone operation, 2 x 20 characters display, 9 keys, 11 status LEDs. 24 Inputs, 26 Outputs. Real time clock, counters, date offsets and much more...!

FAST FACTS	
Printer:	4" Thermal Transfer
Application:	Top, bottom, side or around a corner
Label size:	45 x 300 - 105 x 300 mm
Distance:	0 - 50 mm
<i>Available in both right- and left hand version!</i>	
ACCESSORIES	
<ul style="list-style-type: none"> <li>• TG300 - Handheld terminal</li> <li>• Warning Low Level Media</li> <li>• Cabinets</li> <li>• Label Check in the Applicator Pad</li> <li>• Flashlight/Beacon</li> <li>• Check scanner</li> <li>• Fixed or adjustable stands</li> </ul>	

### Industrial Labelling Systems Ltd.

Unit D4 Brookside Industrial Estate, Greengate, Middleton, Manchester. M24 1GS  
**Tel: 0161 655 4846 Fax: 0161 655 4849 Email: sales@ilsystems.co.uk**  
**www.ilsystems.co.uk**